

52135

Stainless steel long plate

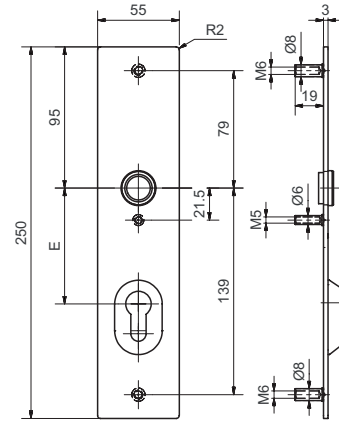

Standard version

- Length: 250 mm
- Width: 55 mm
- Projection: 3 mm
- Satin stainless steel
- 16 mm guide: Glutz glide inwards
- Outside plate with 3 M4 threaded cams (2 x M6, 1 x M5)
- Inside plate 6146C
- For 3 mm cylinder projection

Options

- Polished stainless steel
- RAL lacquered
- PVD lacquered
- 16 mm outside
- Glutz easyfix
- Knob Fixing
- Cylinder protection roses for cylinder projection:
 - RC: 7, 9, 10, 11, 13, 16, 17, 19, 21, 23 mm
 - PC: 7, 9, 11, 13, 15, 17, 19, 21, 23 mm

Cutout

- 52135.0 / 6146.0C blind
- 52135.2 / 6146.2C round cylinder
- 52135.3 / 6146.3C Profile: cylinder

52135 · ① · ② · ③ · ④ · ⑤ · ⑥ · ⑦ · ⑧

① Execution	② Guide	③ Mounting fixe FEHO	④ Guide sleeve	⑤ Cutout	⑥ Centres	⑦ Surface	⑧ Cylinder projection
1 Pair	0 glide	0 ohne	6 3 x M6	00 without	00 ohne	00 Stainless steel matt	00 ohne
2 Piece thread cams	1 twin glide	1 easyfix		02 RZ	72 72 mm	11 Stainless steel polished	06 6 mm
	2 Buttonhole			03 PZ	74 74 mm	44 Antibacterial	08 8 mm
	5 glide ab Ø 23 mm			47 WC 7 mm	78 78 mm	51 RAL 9005 black matt	09 9 mm
	9 blind			48 WC 8 mm	88 88 mm	99 On request	10 10 mm
					90 90 mm		12 12 mm
					92 92 mm		14 14 mm
					94 94 mm		15 15 mm
							16 16 mm
							18 18 mm
							20 20 mm
							22 22 mm