

81221

Garage cylinder, eccentric

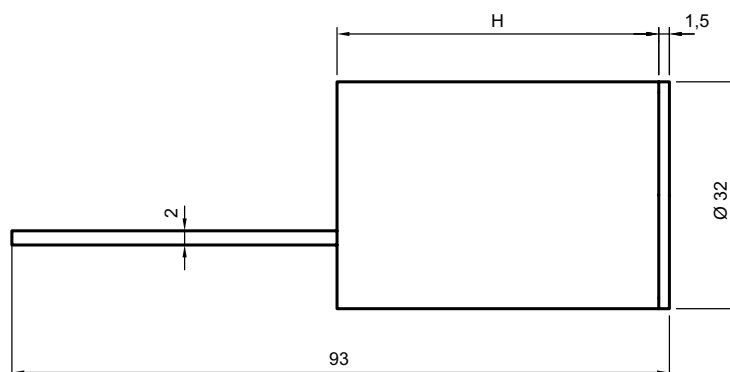

Product profile

for all types of garage doors

Standard version

Satin nickel plated brass

Tail piece length for wood thicknesses from 30 to 80 mm

Tail piece 81530.0

Scope of supply

- 1 Spacer sleeve 81576.4
- 2 Fixing screws 81540.65

81221 • ① • ② • ③

| ① Length | ② Colour A | ③ Tail pieces |
|----------|----------------------------|---------------|
| 35 mm | 0 Satin nickel plated | 0 Standard |
| 40 mm | 1 Polished nickel plated | |
| 45 mm | 2 Polished brass | |
| 50 mm | 3 Satin chrome plated | |
| 55 mm | 4 Polished chrome plated | |
| 60 mm | 5 Black | |
| 65 mm | 6 Antique | |
| 70 mm | 7 Bronzed | |
| 75 mm | 8 Chemically nickel plated | |
| 80 mm | | |