

18991 MINT SV NF

Multipoint lock, self-locking, night time mode



Product profile

For use in house and apartment entrance doors and in commercial buildings. Exiting using the inside lever handle is possible at all times when night function is not activated. When night function (NF) is deliberately switched on via the cylinder, the inside lever handle is blocked. It is only possible to exit using the latch withdrawal function. This means, for example, that children cannot leave the house without using the identification media. Increased break-in protection is provided at the same time as the inside lever handle cannot be tampered with from outside. Operation from outside is via the cylinder/latch withdrawal (knob/pull handle).

To switch night function (NF) on (or off): Turn the key in the locking direction (or unlocking direction) until it stops.

Standard version

- Self-locking with sequence control and latch blocking
- 4-part clamp follower, square 9 mm
- Night function: blockable inside lever handle, lockable follower tested to 80 Nm in accordance with EN 12209.
- Smooth-running latch withdrawal for drawing back the latch
- Hardened main bolt; 20 mm throw
- Two additional hardened bolts; 20 mm throw
- Slider protection: mechanical top/bottom
- Dampened, reversible DIN L+R comfort latch with latch blocking
- Suitable for rotary knob cylinders

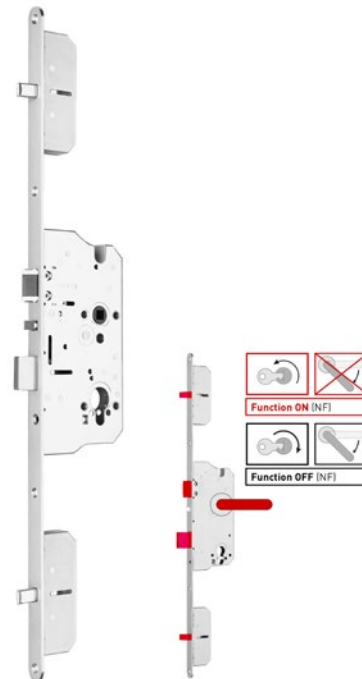

Important note

The cylinder screw is not centred in the forend. To determine the cylinder lengths: centre of forend = centre of lock cylinder.

Do not use a reduction sleeve for the Follower/square spindle.

No external, mechanical bolt-switch contact is recommended.

A button/ push bar has to be used on the outside.

18991 · 1 · 2 · 3 · 4 · 5 · 6 · 7 · 8

	1 Cutout	2 Distance	3 Backset	4 Follower	5 Forend	6 Direction	7 Surface	8 Options
CH	02 RZ	78 78 mm	60 60 mm	9 9,0 mm	02 18r x 1788 mm	0 DIN L	00 Stainless steel matt	0000 No options
	03 PZ		70 70 mm		03 20r x 1788 mm	1 DIN R	99 On request	0110 Radiussed forend extension
			80 80 mm					0130 Renovation forend Treplane
DIN	02 RZ	72 72 mm	65 65 mm	9 9,0 mm	03 20r x 1744 mm	0 DIN L	00 Stainless steel matt	0000 No options
	03 PZ	74 74 mm	70 70 mm			1 DIN R	99 On request	0110 Radiussed forend extension
		92 92 mm	80 80 mm					
		94 94 mm						
0	03 PZ	88 88 mm	65 65 mm	9 9,0 mm	03 20r x 1850 mm	0 DIN L	00 Stainless steel matt	0000 No options
			80 80 mm			1 DIN R	99 On request	0110 Radiussed forend extension

Multipoint lock, self-locking, night time mode

