

## 81052

### RZ thumbturn cylinder with priority function

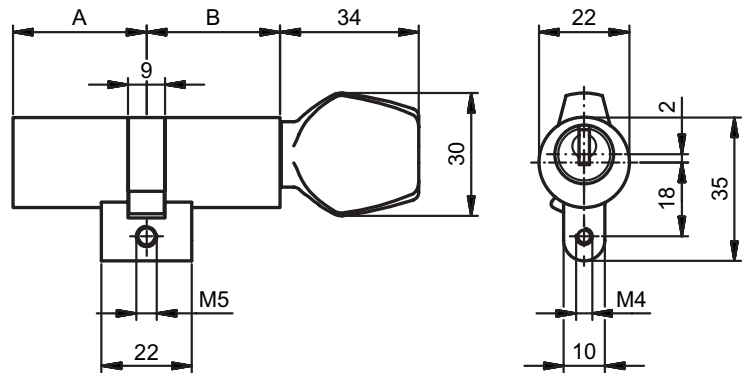

#### Product profile

This cylinder features a special coupler which guarantees priority for the outer cylinder side or a key inserted from the outside at all times. This means that it can be opened with the key from outside, even if the knob is being held tight from inside. For schools, hospitals, nursing homes and seniors' residences.

#### Standard version

brass satin nickel plated

#### Scope of supply

- fixing screw 81540.75

#### Important note

Drill protection class «D» according to EN 1303: 2015

81052 · ① · ② · ③ · ④ · ⑤ · ⑥ · ⑦

① Version

② Length A

③ Length B

④ Colour A

⑤ Colour B

⑥ Security

⑦ Thumbturn

|                       |                |                |                              |                    |                       |
|-----------------------|----------------|----------------|------------------------------|--------------------|-----------------------|
| <b>S</b> Standard cam | <b>32,5 mm</b> | <b>32,5 mm</b> | <b>0</b> Satin nickel plated | <b>0</b> Standard  | <b>0</b> Glutz design |
|                       | 37,5 mm        | 37,5 mm        | 1 Polished nickel plated     | 1 Drill protection | 1 Round               |
|                       | 42,5 mm        | 42,5 mm        | 2 Polished brass             |                    |                       |
|                       | 47,5 mm        | 47,5 mm        | 3 Satin chrome plated        |                    |                       |
|                       | 52,5 mm        | 52,5 mm        | 4 Polished chrome plated     |                    |                       |
|                       | 57,5 mm        | 57,5 mm        | 5 Black                      |                    |                       |
|                       | 62,5 mm        | 62,5 mm        | 6 Antique                    |                    |                       |
|                       | 67,5 mm        | 67,5 mm        | 7 Bronzed                    |                    |                       |
|                       | 72,5 mm        | 72,5 mm        | 8 Chemically nickel plated   |                    |                       |
|                       | 77,5 mm        | 77,5 mm        |                              |                    |                       |
| 82,5 mm               | 82,5 mm        |                |                              |                    |                       |