

52192

Stainless steel metal frame long plate

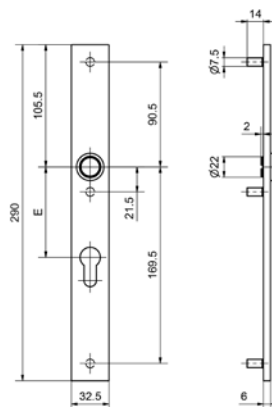

Product profile

Exterior plate with spring loaded lever handle,
fixed mobile mounting and delivered as half-fitting
Specify DIN left hand or DIN right hand version

RAL lacquered

PVD lacquered

Standard version

Length: 290 mm

Width: 32,5 mm

Projection: 6 mm

Satin stainless steel

16 mm guide Glutz glide inwards

With 3 threaded cam M5

Cutout

52192.0 blank

52192.2 RZ Distances (E): 74 mm, 78 mm, 94 mm

52192.3 PZ Distances (E): 72 mm, 78 mm, 92 mm

52192.4 WC with indicator Distances (E): 78 mm / spindle 7 mm

52192.41WC without indicator Distances (E): 78 mm / spindle 7 mm

Options

Polished stainless steel