

52193

Stainless steel metal frame long plate

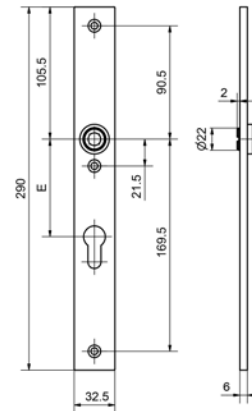

Product profile

Interior plate with spring loaded lever handle,
fixed mobile mounting and delivered as half-fitting.
Specify DIN left hand or DIN right hand version

Standard version

Satin stainless steel
Length: 290 mm
Width: 32,5 mm
Projection: 6 mm
16 mm guide: Glutz glide inwards
With 3 fixing holes M5

Cutout

52193.0 blank
52193.2 RZ Distances (E): 74 mm, 78 mm, 94 mm
52193.3 PZ Distances (E): 72 mm, 78 mm, 92 mm
52193.4 WC with thumbturn for 7 mm spindle

Options

Polished stainless steel
RAL lacquered
PVD lacquered