

## 6116 DCV

Spindle rose with cover

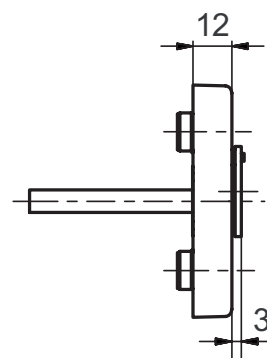
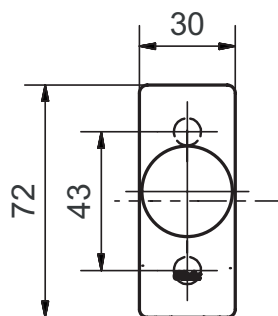

### Standard version

Satin stainless steel  
With cover  
Clip on rose  
Square spindle 7 x 38 mm  
Fixing centres 43 mm

### Options

Length: of square spindle 7 x 24, 26, 32, 35, 40, 114 mm (other spindle Lengths: upon request)  
Polished stainless steel  
RAL lacquered  
PVD lacquered