

## 52196

### Stainless steel metal frame long plate

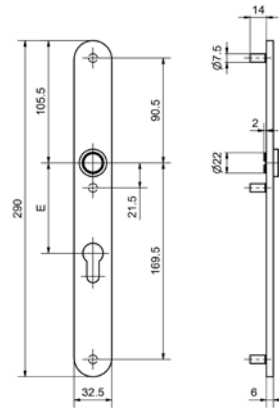

#### Product profile

Exterior plate with spring loaded lever handle,  
fixed mobile mounting and delivered as half-fitting  
Specify DIN left hand or DIN right hand version

RAL lacquered

PVD lacquered

#### Standard version

Length: 290 mm

Width: 32,5 mm

Projection: 6 mm

Satin stainless steel

16 mm guide Glutz glide inwards

With 3 threaded cam M5

#### Cutout

52196.0 blank

52196.2 RZ Distances (E): 74 mm, 78 mm, 94 mm

52196.3 PZ Distances (E): 72 mm, 78 mm, 92 mm

52196.4 WC with indicator Distances (E): 78 mm / spindle 7 mm

52196.41WC without indicator Distances (E): 78 mm / spindle 7 mm

#### Options

Polished stainless steel