

59121

Stepped spindle with stop

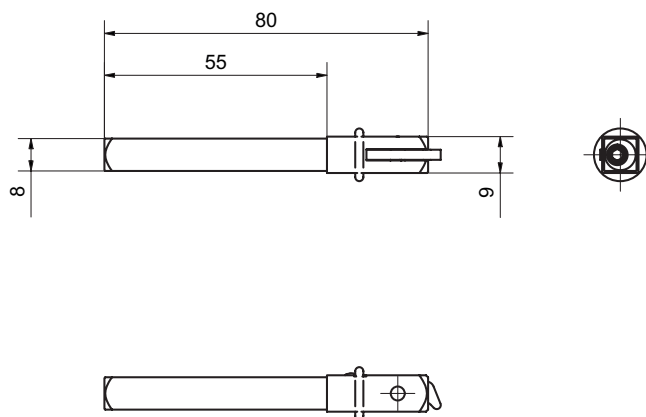

Product profile

For one-sided lever handle mounting (not approved for EN 179)

Standard version

With eccentric bore on the one side

Stainless steel

9 mm to 8 mm x 80 mm / 32 mm shortened

59121 · ① · ② · ③

① Square	② Bolt length	③ Square material
95 9 mm auf 8 mm	080 80 mm	2 Stainless steel