

33002/51001 CF

Stainless steel window handle

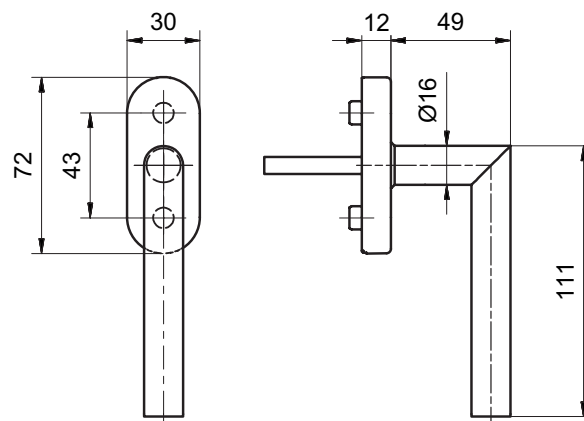

Product profile

Superior quality residential developments

Standard version

Satin stainless steel surface, Ø 16 mm

Handle length 111 mm

Handle projection 49 mm

Total projection 61 mm

4 x 90° ball stop

Square spindle 7 x 38 mm

Fixing centres 43 mm

Studs Ø 9.5/12 mm

Clip on rose 51001 CF round

Clip on rose 51002 CF square

72 x 29 x 12 mm

Options

Length: of square spindle 7 x 24, 26, 32, 35, 40 mm (other spindle

Lengths: upon request)

Polished stainless steel

33002/51001 CF · ① · ②

① Bolt length

24 24mm

26 26mm

32 32mm

35 35mm

38 38 mm

40 40mm

② Surface

00 Stainless steel matt

11 Stainless steel polished

44 Antibacterial

51 RAL 9005 black matt

99 On request