

5057/5616 CF Thun

Stainless steel window handle

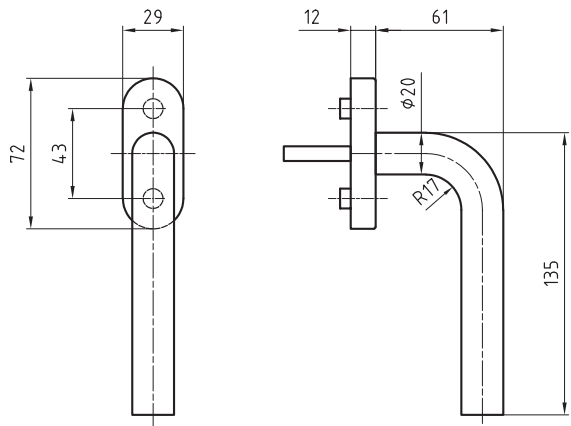

Product profile

Commercial buildings, administrative centres and superior quality residential developments

Standard version

Satin stainless steel surface, Ø 20 mm
Handle length 135 mm
Handle projection 61 mm
Total projection 73 mm
4 x 90° ball stop
Square spindle 7 x 38 mm
Fixing centres 43 mm
Studs Ø 9.5/12 mm

Clip-on rose 5616 CF
72 x 29 x 12 mm

Important note

Fixed mobile mounting on rose, concealed screws
M5 screws must be ordered separately

5057/5616 CF · ① · ②

① Bolt length	② Surface
24 24mm	00 Stainless steel matt
26 26mm	11 Stainless steel polished
32 32mm	44 Antibacterial
35 35mm	51 RAL 9005 black matt
38 38 mm	99 On request
40 40mm	
99 On request	