

## 5465 | 5465K | 5435C | 5467

Stainless steel security plate ES 2

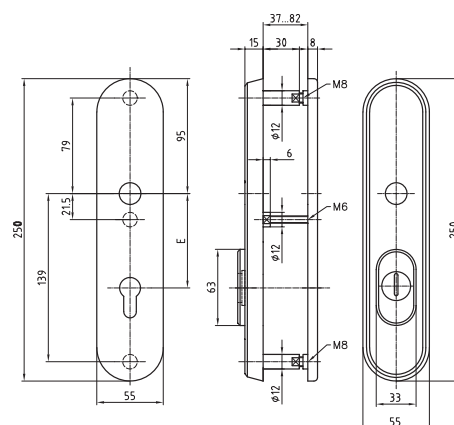

### Product profile

For burglar resistant doors RC 3 according to EN 1627 - 1630: 2011

### Standard version

Outer plate 250 x 55 x 15 mm

Prepared for cylinder cover

Satin stainless steel

16 mm guide: Glutz glide inwards

5465 for door handle operation

5465K for door knob operation

Inside plate 5435C 250 x 55 x 8 mm

Satin stainless steel

16 mm guide: Glutz glide inwards

Base plate with guide cam

Centres:

PZ: 70 mm, 72 mm, 78 mm, 88 mm, 92 mm

RZ: 74 mm, 78 mm, 94 mm

Cylinder cover

No. 1: cylinder Projection: 7 - 12 mm

No. 2: cylinder Projection: 12 - 17 mm

No 3: cylinder Projection: 17 - 22 mm

No 4: cylinder Projection: 22 - 27 mm

### Options

Polished stainless steel

RAL lacquered

PVD lacquered

16 mm twin, semi-outside

Glutz easyfix

Inner plate 5467 solid 250 x 55 x 6 mm

Inside plate 5436.2C conic 12 mm for SEAvision

Inside plate 5437.2C conic 18 mm

SEAvision Powerpack or KABA-Elostar

### Standards

ES2-L-ZA, DIN 18257: 2003-03

Resistance class 3, EN 1906: 2002-05

### Important note

When using in combination with KABA Elostar, it is essential to use long-type keys!