

Boxed striking plate as center striking plate

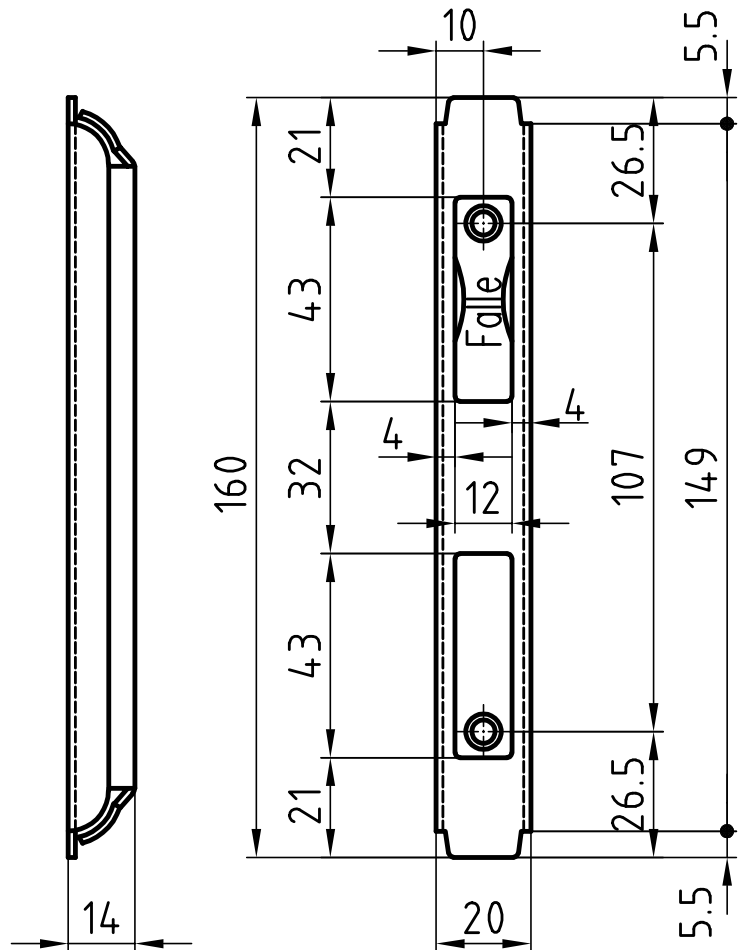

High-quality boxed striking plate in stainless steel for the mortice locks Swiss, series 1004, 11 and 12 in the versions with distance 78 mm.

- X-Dimension (X-Mass): 4 mm
- Distance: 78 mm
- Width: 20 mm
- Length: 160 mm
- Depth: 14 mm
- DIN L and R
- Matt stainless steel

- Series 40.200 for routers

The striking plate is not approved for the heavy-duty mortice lock with anti-friction lever latch 1105KF.

Important note