

6182 | 52182

Stainless steel security plate ES 1 - RZ

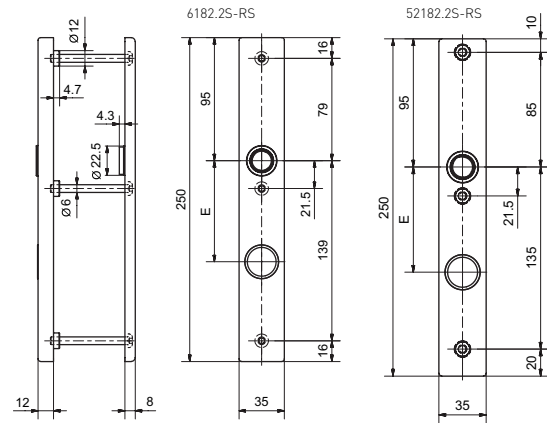
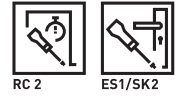

Product profile

For burglar resistant doors RC 1+2 according to EN 1627 - 1630: 2011

Standards

ES1-L, DIN 18257: 2003-03

Resistance class 2, EN 1906: 2010-09

Standard version

Satin stainless steel

16 mm guide for Glutz glide

Outer plate 250 x 35 x 12 mm

Prepared for round cylinder protection roses

5473/1: cylinder Projection: 10 - 15 mm

5473/2: cylinder Projection: 15 - 18 mm

5473/3: cylinder Projection: 18 - 21 mm

Inside plate 6165.2C 250 x 35 x 8 mm

Centres RZ: 74 mm, 78 mm, 94 mm

Fixing Centres:

6182: 79 mm / 139 mm, 52182: 85 mm / 135 mm

6182 | 52182 · ① · ② · ③ · ④ · ⑤ · ⑥ · ⑦

① Execution	② Guide	③ Mounting fixe FEHO	④ Guide sleeve	⑤ Cutout	⑥ Centres	⑦ Surface
6 Stück	0 glide 2 Buttonhole 4 twin glide auswärts	0 ohne 1 easyfix	6 3 x M6	02 RZ 03 PZ 08 PRZ	72 72 mm 74 74 mm 78 78 mm 92 92 mm 94 94 mm	00 Stainless steel matt 11 Stainless steel polished 44 Antibacterial 51 RAL 9005 black matt 99 On request