

## 83304 Double-knob E cylinder

EE / PZ

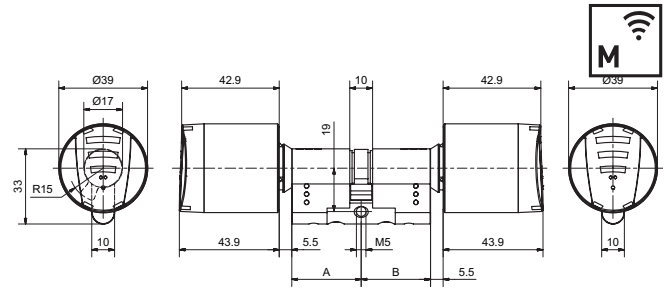
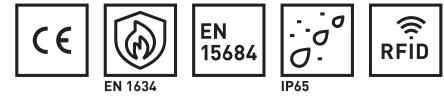

### Product profile

Battery-operated electronic cylinder for interior and exterior doors. Opening and closing from outside and inside is done by contactless reading of the RFID medium and subsequent turning of the knob.

### Standard version

- Exterior E knob with access control function and battery
- Interior E knob with access control function and battery
- Identification via RFID Mifare DESfire EV1 (ISO 14443A)
- Programming via media or wireless access (868 MHz)
- Protection class: IP65, EN 15684
- Security: Predetermined breaking point on the knob, rotation brake, anti-drilling and core extraction protection, 3DES encryption
- Installation only possible in correct position

### Scope of supply

- E-knobs for E-cylinder, including batteries
- E-Module

### Standards

- EN 15684: 1|6|B|3|A|F|3|2
- EN 1634-2: 90 Min. both sides

### 83304 · ① · ② · ③ · ④ · ⑤ · ⑥ · ⑦ · ⑧

① Version	② Length A (Outside)	③ Length B (inside)	④ Surface Outside ⑤ Surface inside	⑥ Security	⑦ Knob type	⑧ Reading system
<b>S Standard</b>	<b>31,0</b> mm (Base length)	<b>31,0</b> mm (Base length)	<b>0 Nickel plated</b>	<b>0 Standard</b>	<b>0 No mech. Knob</b>	<b>0 Mifare</b>
<b>L FZG</b>	<b>36,0</b> mm (+05 mm)	<b>36,0</b> mm (+05 mm)	<b>1 Nickel polished</b>			
<b>F FAP</b>	<b>41,0</b> mm (+10 mm)	<b>41,0</b> mm (+10 mm)	<b>2 Brass polished</b>			
<b>M Pinion 10</b>	<b>46,0</b> mm (+15 mm)	<b>46,0</b> mm (+15 mm)				
<b>I Biffar</b>	<b>51,0</b> mm (+20 mm)	<b>51,0</b> mm (+20 mm)				
<b>Q Pinion 18</b>	<b>56,0</b> mm (+25 mm)	<b>56,0</b> mm (+25 mm)				
	<b>61,0</b> mm (+30 mm)	<b>61,0</b> mm (+30 mm)				
	<b>66,0</b> mm (+35 mm)	<b>66,0</b> mm (+35 mm)				
	<b>71,0</b> mm (+40 mm)	<b>71,0</b> mm (+40 mm)				
	<b>76,0</b> mm (+45 mm)	<b>76,0</b> mm (+45 mm)				
	<b>81,0</b> mm (+50 mm)	<b>81,0</b> mm (+50 mm)				
	<b>86,0</b> mm (+55 mm)	<b>86,0</b> mm (+55 mm)				
	<b>91,0</b> mm (+60 mm)	<b>91,0</b> mm (+60 mm)				

FZG: Freewheeling function for freewheeling locks, FAP: anti-panic function, Follower reset for panic locks, minimum length on one side 61mm

Technical changes reserved 0821